

COPY



## Memorandum

*Tyler S. Ferguson  
Development Engineer*

*To: All Address Map Holders*

*Date: May 2, 2006*

*Re: City of Wheaton Address Map Changes*

*Listed below are changes to the City of Wheaton address map:*

	<i>Old address</i>	<i>New address</i>
1	26W575 Embden Lane **	2306 Embden Lane
2	26W586 Embden Lane **	2315 Embden Lane
3	26W 595 Embden Lane**	2318 Embden Lane
4	26W598 Embden Lane**	2327 Embden Lane
5	27W 005 Embden Lane**	2330 Embden Lane
6	1303 N. Cross (two lot subdivision)	1307 N. Cross Street New lot
7	1044 Golf Lane (two lot subdivision)	1040 Golf Lane New Lot
8	Wescott Crossing development	See Map Cross, Front, Scott and Wesley
9	1103 N. President (two lot subdivision)	1111 N. President Street New Lot
10	666 S. Main Wheaton Park District	600 S. Main Street
11	2200 N. Main	See Map/new commercial Development
12	Geneva Lakes Plaza **annexation	See Map/new commercial Development
13	Mackenzie Place Phase II**	See revised map for this area
14	203 E. Liberty	101 N. Cross Street
15	Wheaton North Commons **	See Map/new commercial Development
16	1104 N Wheaton	307 W Oak Street

**\*\* DENOTES ANNEXATION**

*Cc DuComm*

*All City Departments*

**ADDRESS MAP HOLDERS LIST**

COPY

1 ~ S

1. 26W595 Embden is now 2318
2. 26W598 Embden is now 2327
3. 27W005 Embden is now 2330

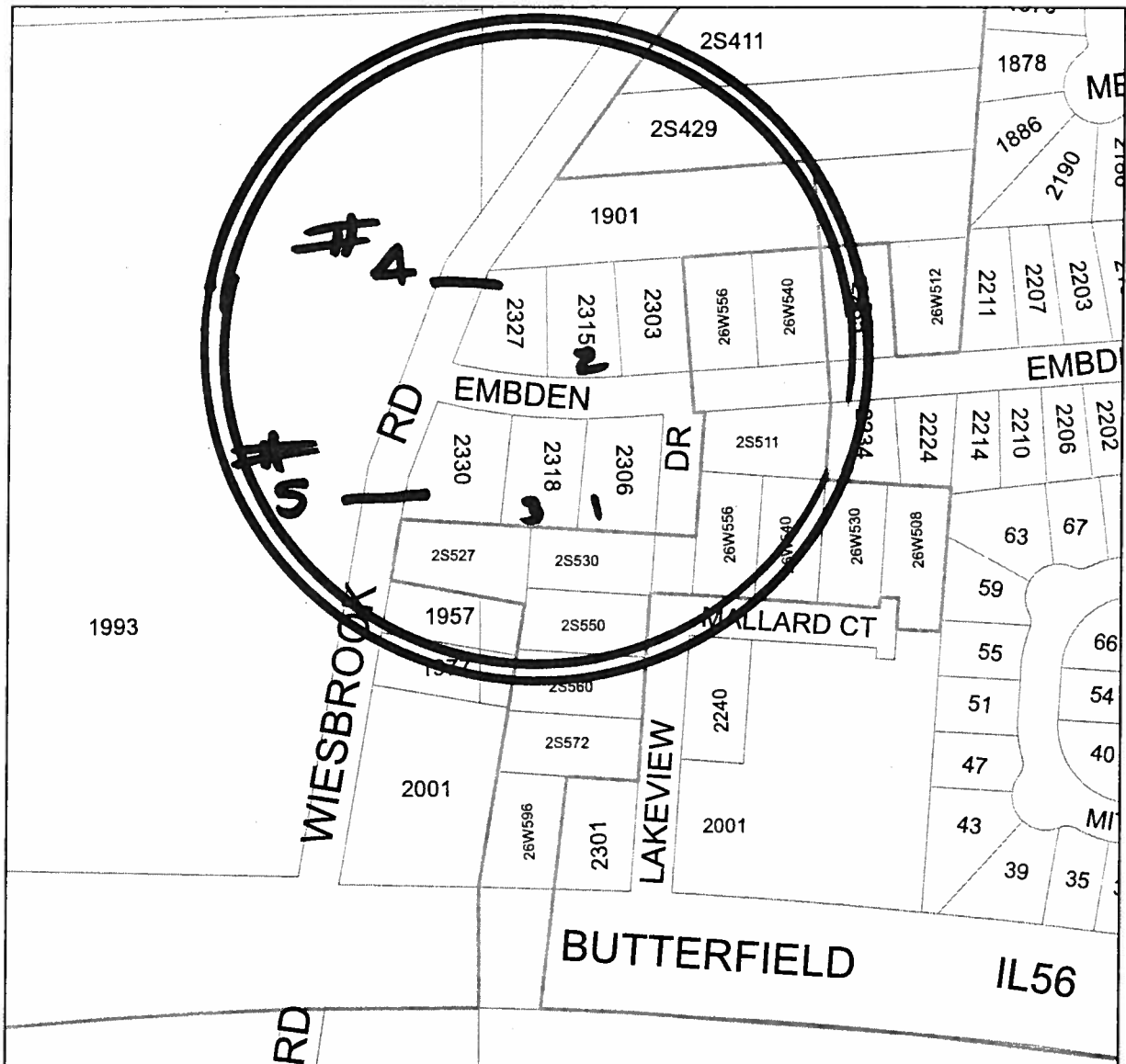

#6

Address Change: 1307 N. Cross Street  
(formerly 1303 N. Cross Street)

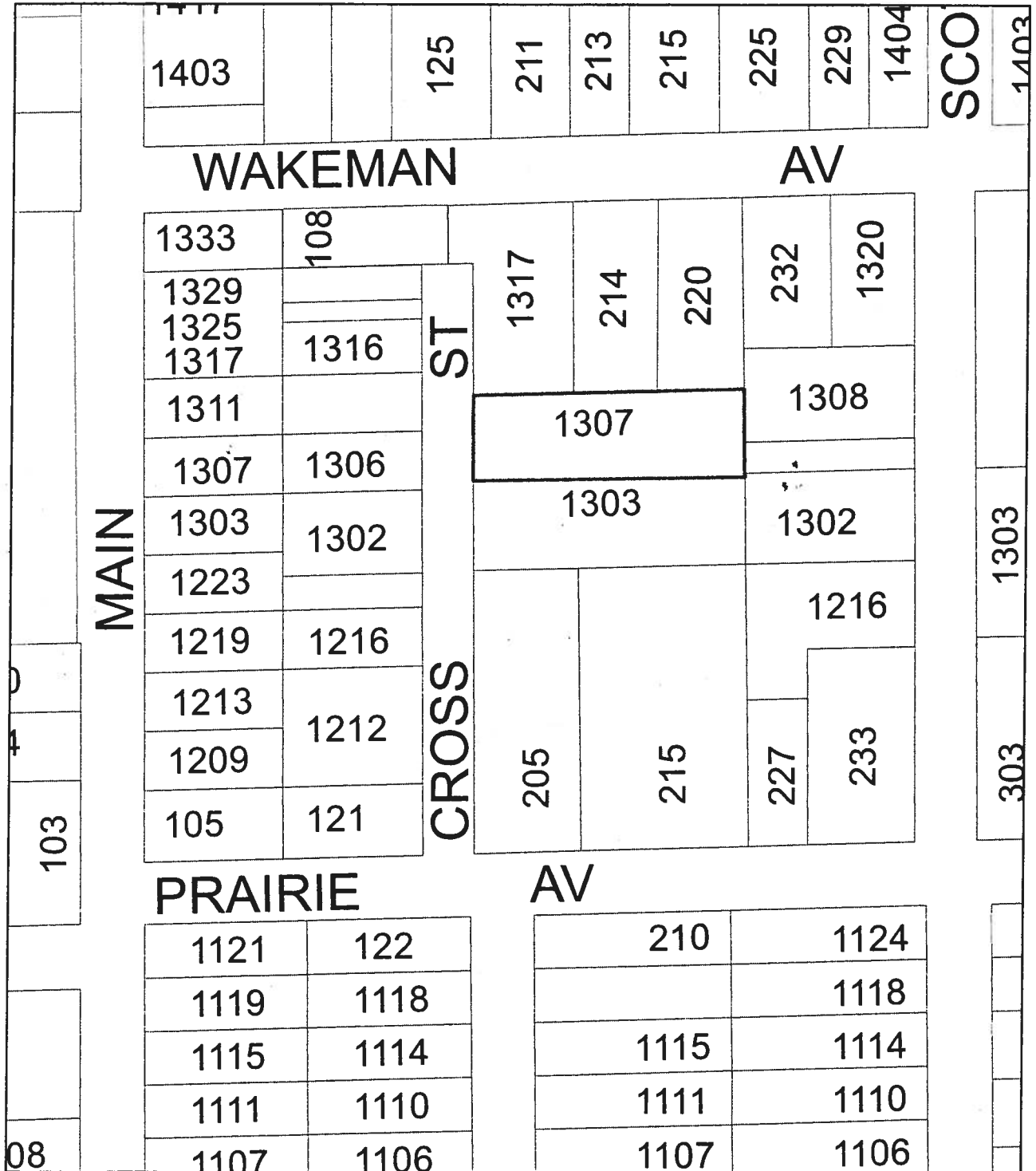

1 inch equals 150 feet

# 7

1040 Golf Lane  
1044 Golf Lane

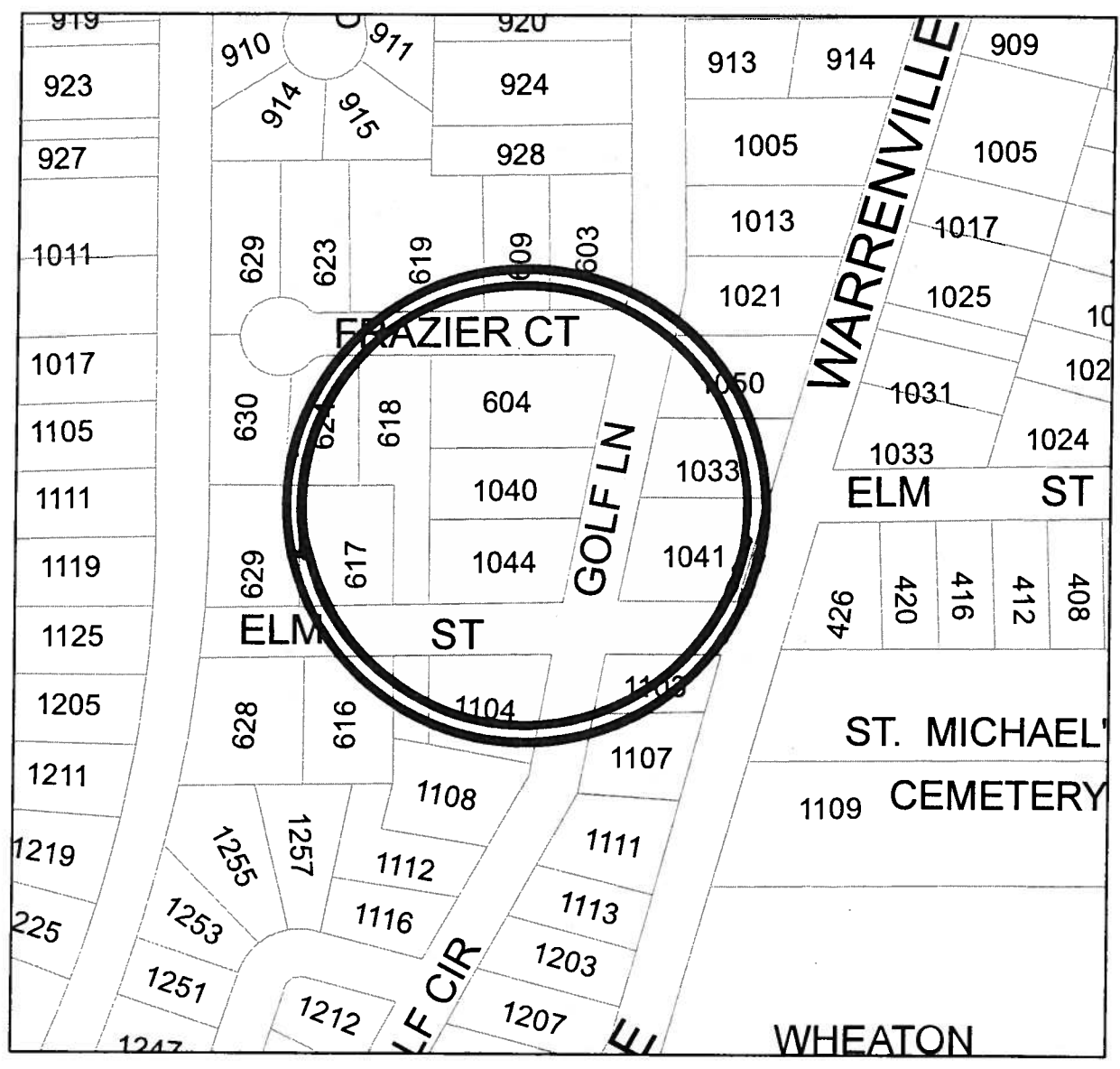

# 00

# Wescott Crossing

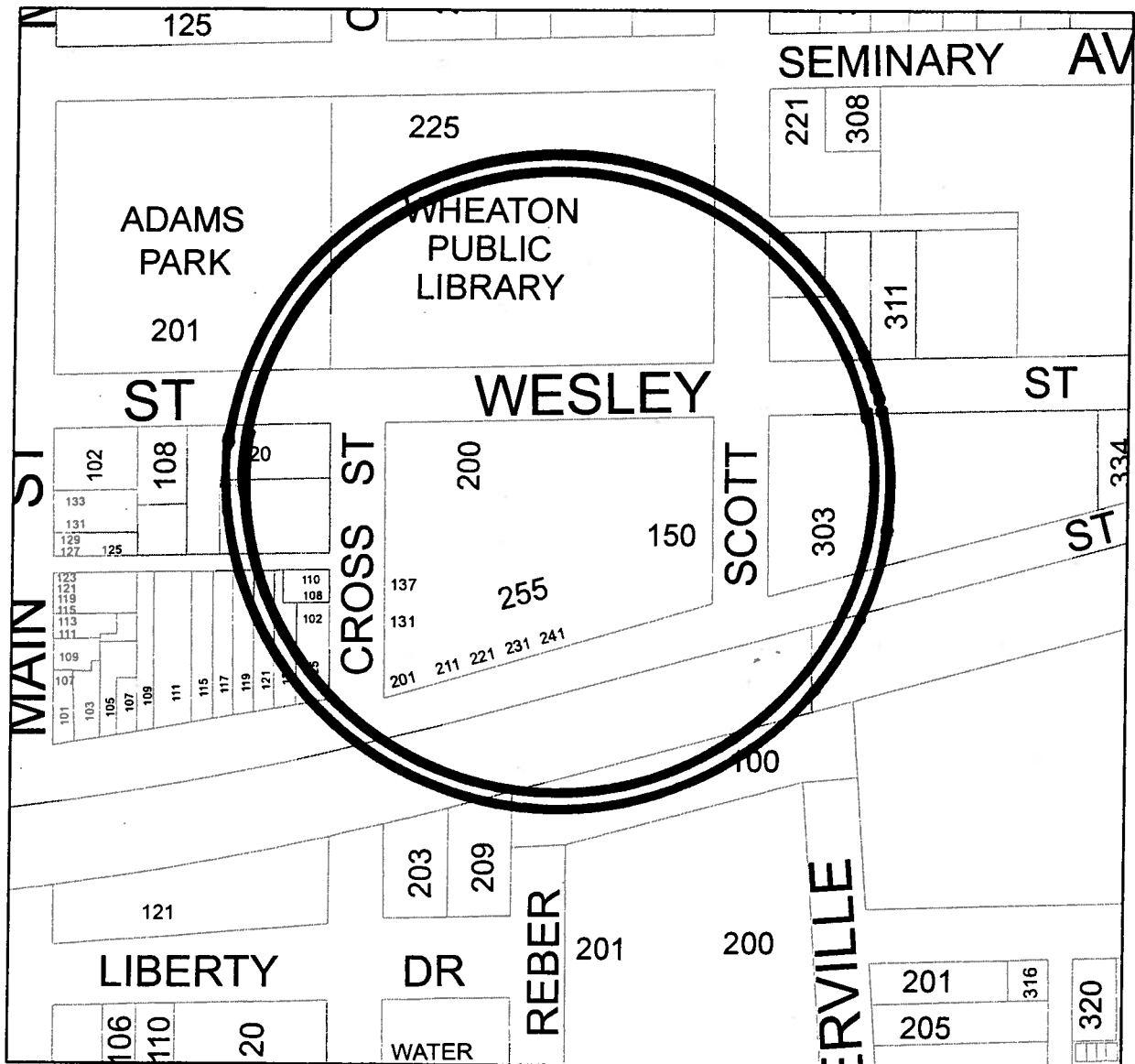

COPY #9

# Subdivision 1103 & 1111 N. President Street

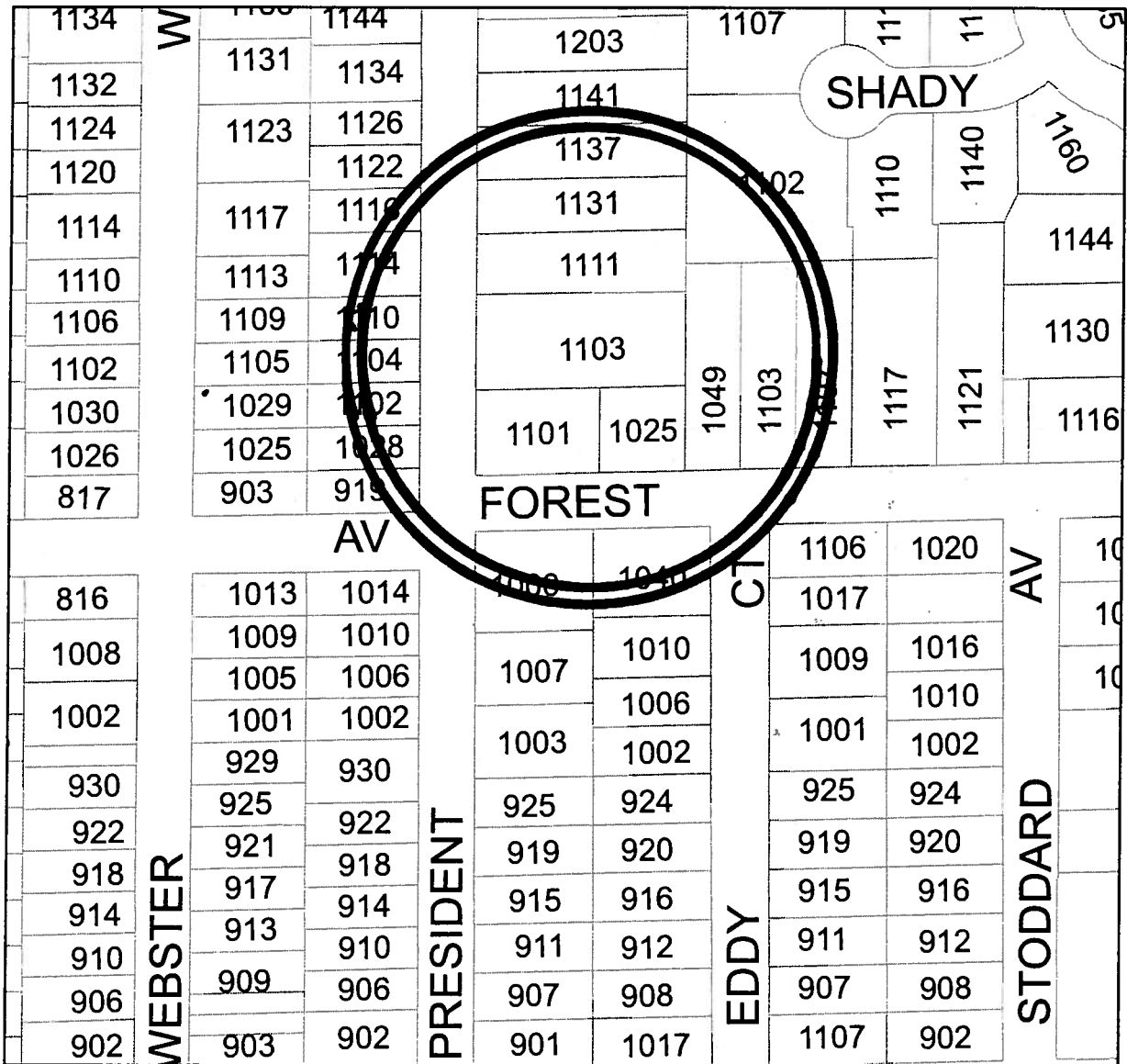





# 11

# Address Changes NW Corner of Main St & Geneva Road (formerly Wilton Manor)

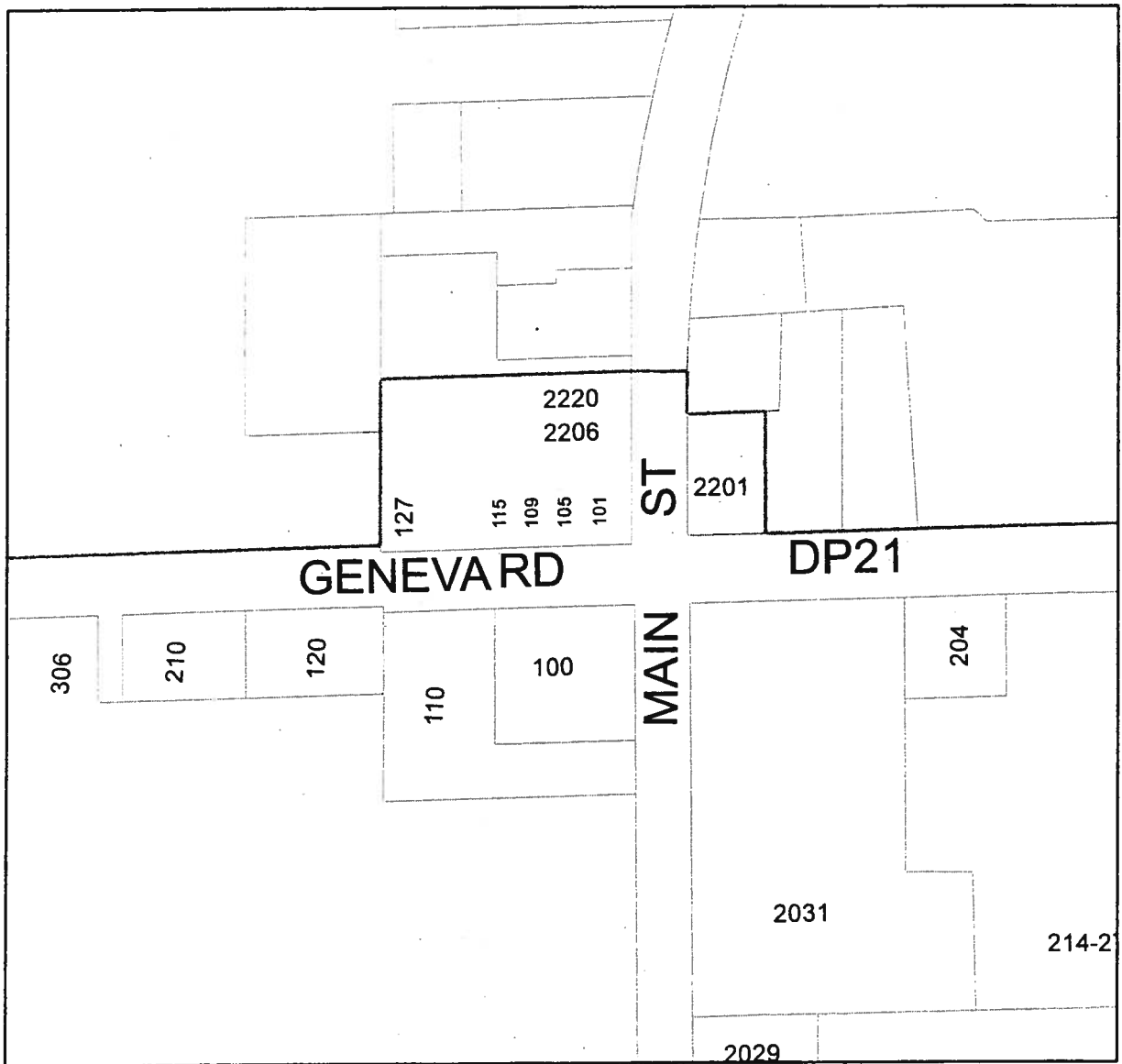

#12

Geneva Lakes  
Gary Ave & Geneva Road

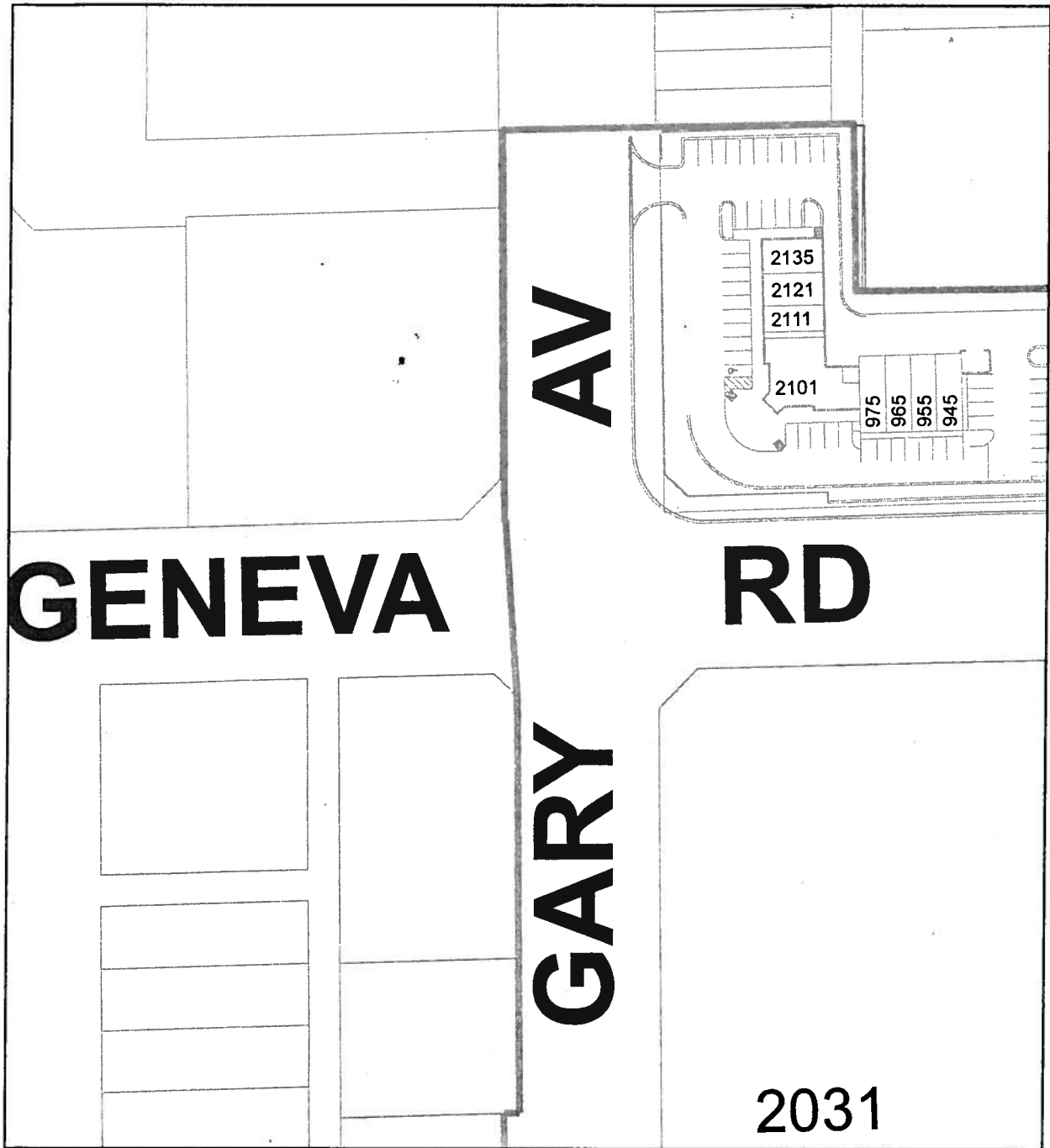

# Mackenzie Place Phase II

# 13

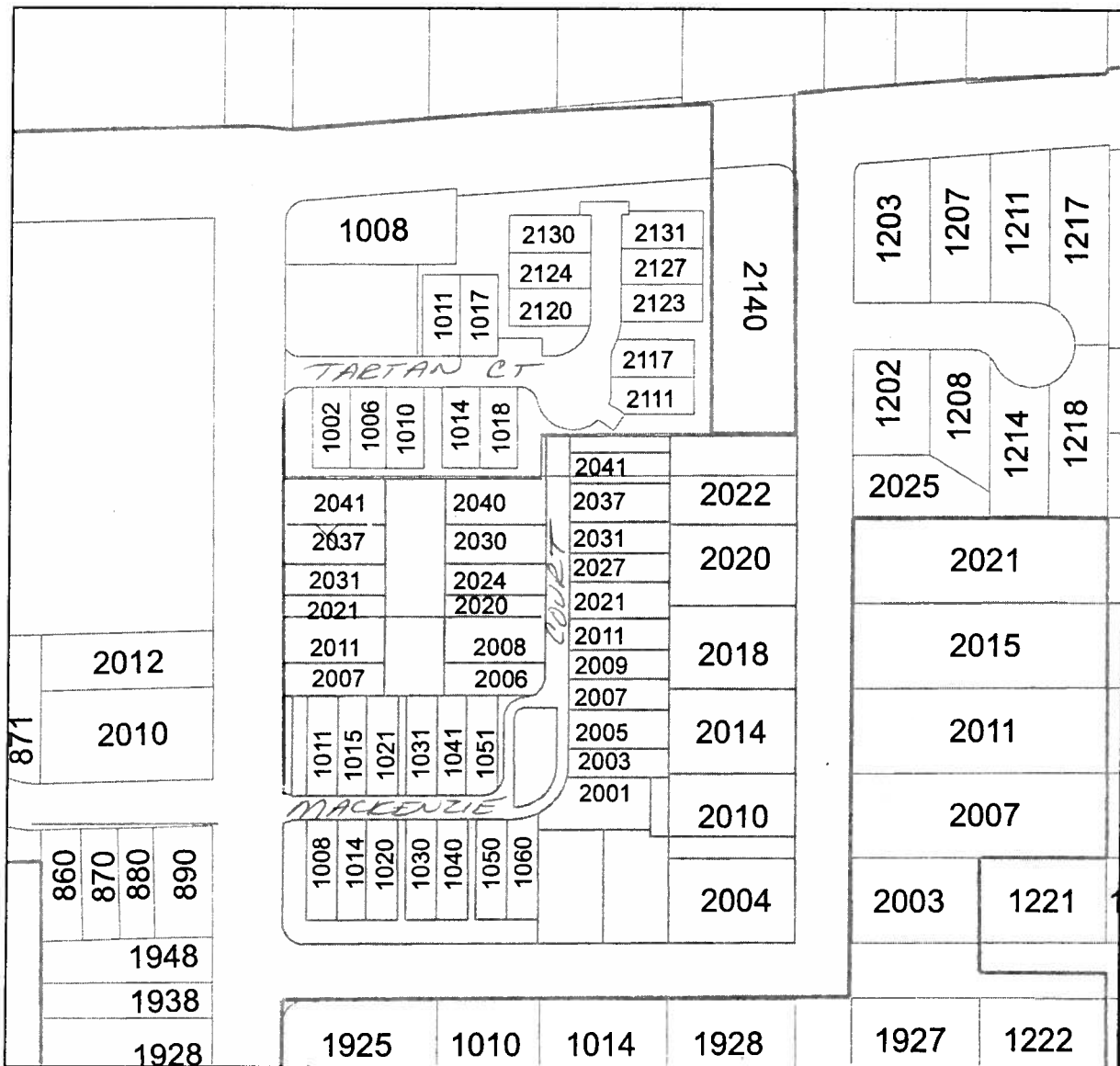

#14

Address Change  
101 N. Cross Street (formerly 203 E. Liberty)

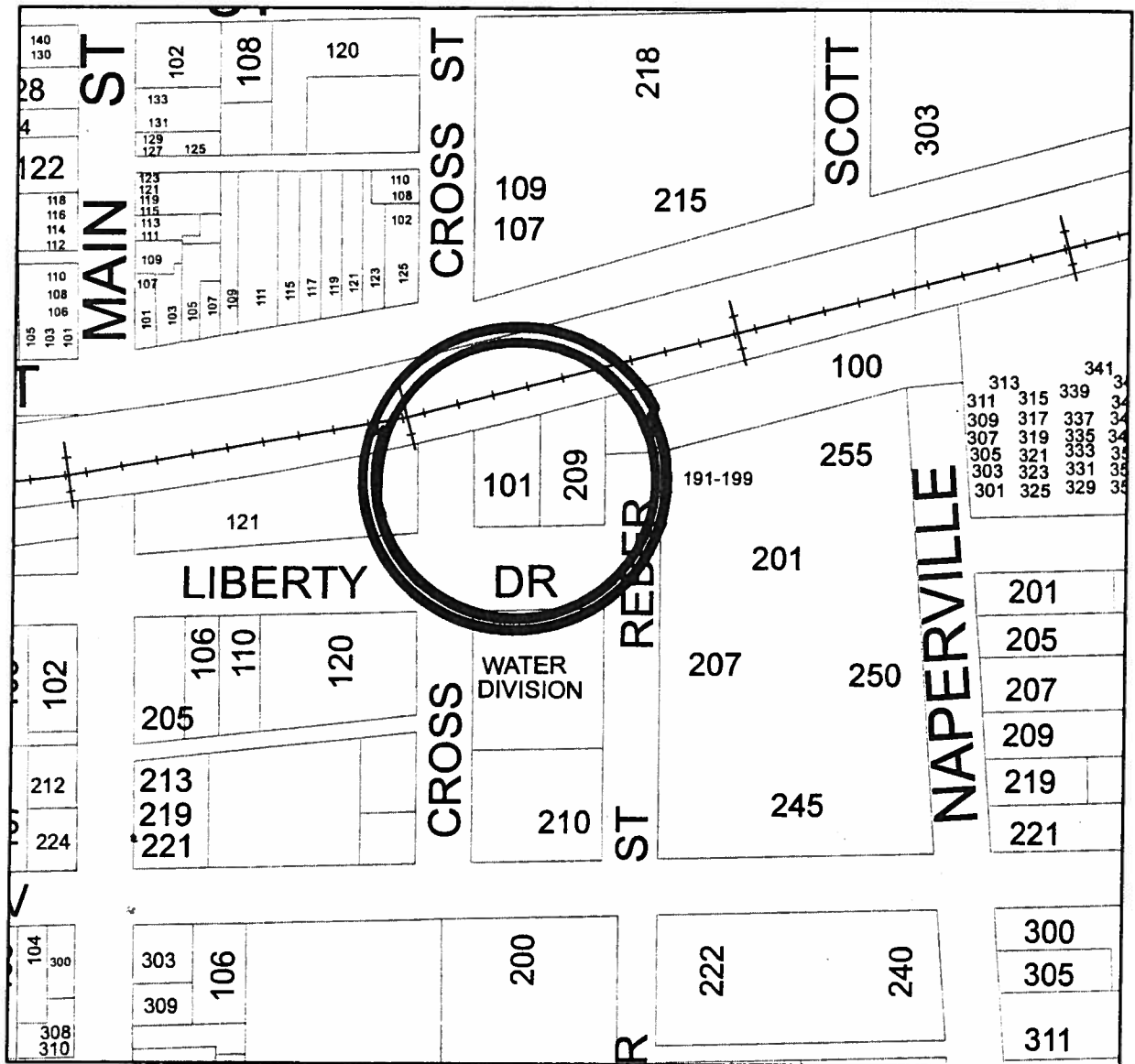

# 15

# New Addresses Wheaton North Commons

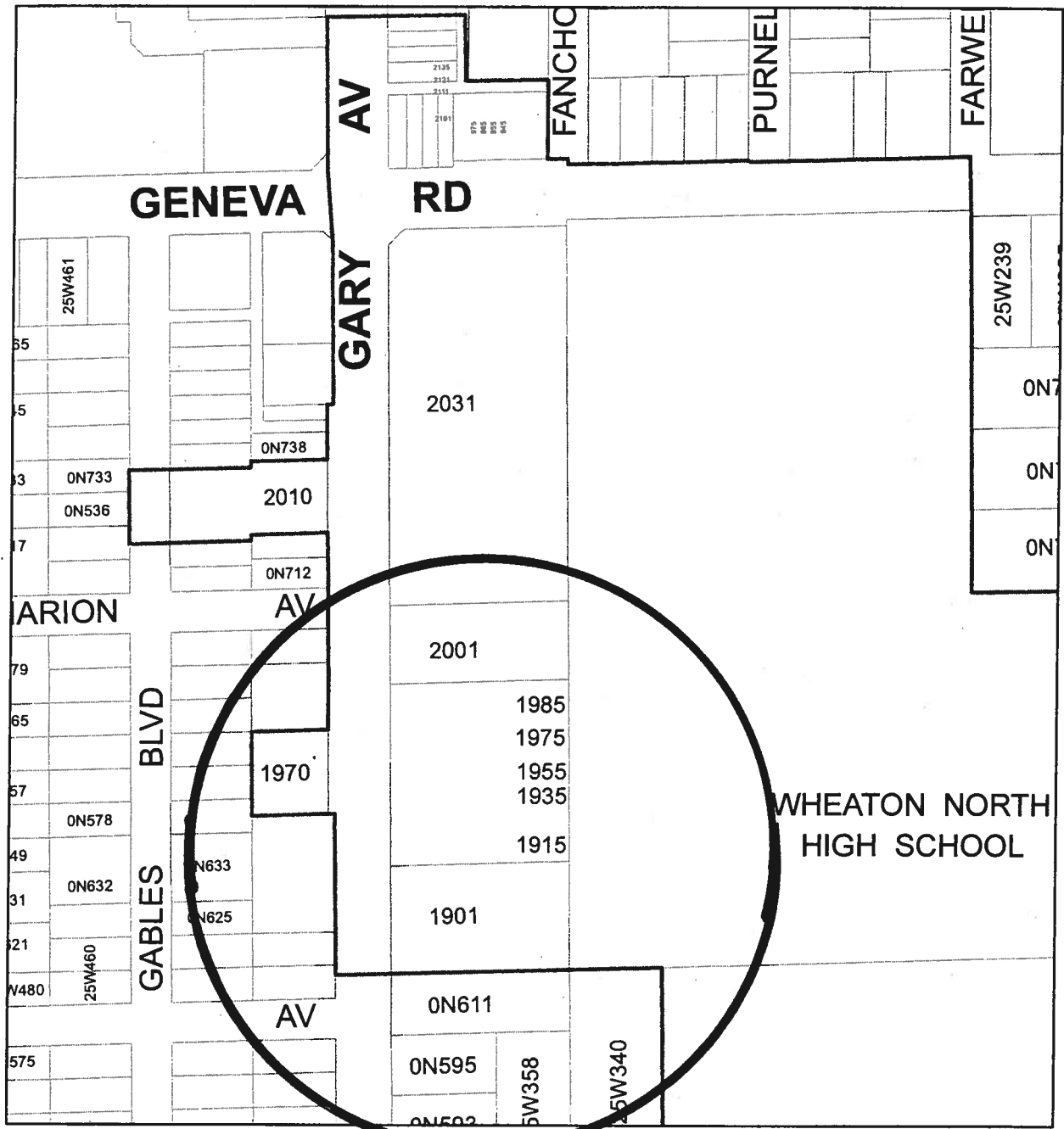

#16

Address Change  
307 W. Oak (formerly 1104 N. Wheaton Ave.)

