

ORDINANCE NO. F-1896

AN ORDINANCE AMENDING ORDINANCE NO. F-1390 “AN ORDINANCE AMENDING THE WHEATON ZONING MAP BY GRANTING A SPECIAL USE PERMIT TO ALLOW A CAR WASH AND AN AUTOMOBILE REPAIR FACILITY IN THE C-3 GENERAL BUSINESS DISTRICT - 1520 EAST ROOSEVELT ROAD/ HILLER”

WHEREAS, on November 17, 2008, the City of Wheaton, Illinois (“City”), enacted City Ordinance No. F-1390, “AN ORDINANCE AMENDING THE WHEATON ZONING MAP BY GRANTING A SPECIAL USE PERMIT TO ALLOW A CAR WASH AND AN AUTOMOBILE REPAIR FACILITY IN THE C-3 GENERAL BUSINESS DISTRICT - 1520 EAST ROOSEVELT ROAD/ HILLER” “Original Ordinance”, which granted a special use permit to allow a car wash and an automobile repair facility in the C-3 General Business District, all on the property legally described herein within the city limits of Wheaton, Illinois, and commonly known as 1520 East Roosevelt Road, Wheaton, IL; (“Subject Property”) and

WHEREAS, following the enactment of the Original Ordinance, an application has been made to amend the existing special use permit to allow the construction and use of an addition to the existing car wash located at 1520 East Roosevelt Road, Wheaton, IL; and

WHEREAS, pursuant to notice as required by the Illinois Municipal Code and the Wheaton Zoning Ordinance, a public hearing was conducted by the Wheaton Planning and Zoning Board on October 13, 2015 to consider a proposed amendment to the special use permit amendment; and the Board has recommended the issuance of an amendment to the special use permit.

NOW, THEREFORE, BE IT ORDAINED by the City Council of the City of Wheaton, Du Page County, Illinois, pursuant to its home rule powers, as follows:

Section 1: The following described property has been and continues to be zoned and classified in the C-3 General Business District zoning classification:

PARCEL 1: LOTS 1, 2 (EXCEPT THE NORTH 5 FEET THEREOF TAKEN FOR ROAD PURPOSES IN CASE NO. 89 ED-30) AND ALL OF LOTS 19 AND 20 IN BLOCK 31 IN WHEATON ESTATES BEING A SUBDIVISION IN SECTION 22, TOWNSHIP 39 NORTH, RANGE 10, EAST OF THE THIRD PRINCIPAL MERIDIAN, ACCORDING TO THE PLAT THEREOF RECORDED SEPTEMBER 12, 1924 AS DOCUMENT 182391, IN DUPAGE COUNTY, ILLINOIS.

PARCEL 2: THE WESTERLY 33 FEET OF THAT PART OF PROSPECT AVANUE LYING EAST OF AN ADJACENT TO LOTS 1 AND 20, BLOCK 31 IN WHEATON ESTATES, A SUBDIVISION IN SECTION 22, TOWNSHIP 39 NORTH, RANGE 10 EAST OF THE THIRD PRINCIPAL MERIDIAN ACCORDING TO THE PLAT THEREOF RECORDED SEPTEMBER 12, 1924 AS DOCUMENT NO. 182391 IN DUPAGE COUNTY, ILLINOIS AND CONSISTING OF 8,547 SQAURE FEET.

PIN: 05-22-102-024

The subject property is commonly known as 1520 East Roosevelt Road, Wheaton, Illinois 60187.

Section 2: Pursuant to the Findings of Fact made and determined by the Planning and Zoning Board, an amendment to the special use permit is hereby issued on the subject property to allow an addition to the existing car wash in the C-3 General Business District, in full compliance with the amended site plan and building elevations entitled “Wheaton Car Wash, 1520 East Roosevelt Road” prepared by

DM+S Architects, Westmont, Illinois, dated May 8, 2015.

Section 3: In all other respects, the terms and conditions of the Original Ordinance are ratified and remain in full force and effect.

Section 4: All ordinances or parts of ordinances in conflict with these provisions are repealed.

Section 5: This ordinance shall become effective from and after its passage, approval, and publication in pamphlet form in the manner prescribed by law.



Mayor

ATTEST:

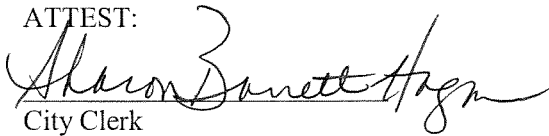

City Clerk

ROLL CALL VOTE

Ayes: Councilman Saline
Councilman Scalzo
Councilwoman Fitch
Councilman Prendiville
Councilman Rutledge
Mayor Gresk

Nays: None

Absent: Councilman Sues

Motion Carried Unanimously

Passed: November 2, 2015

Published: November 3, 2015

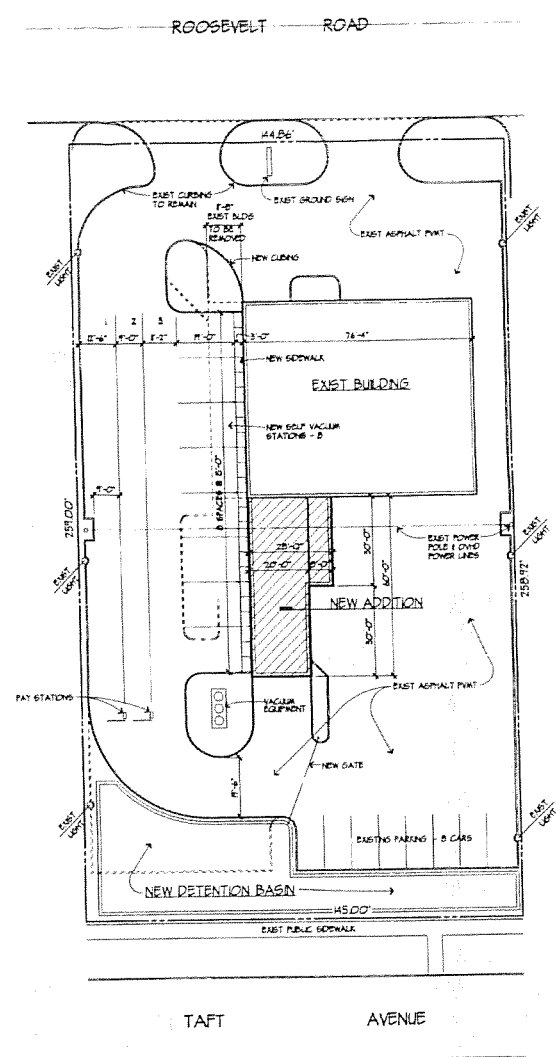

SITE DATA	
SITE AREA	10,267 ACRES
BUILDING AREA	51,555 SF
EXISTING BUILDING	4,191 SF
NEW TUNNEL ADDITION	1,440 SF
TOTAL NEW/EXIST BUILDING AREA	6,427 SF
USE COVERAGE	0%
PARKING PROVIDED	8 C
EXISTING PARKING	0 C

SITE PLAN
SCALE 1/4"=1'-0"

DM+S ARCHITECTS, P.C.
117 HEATH PLACE
WHEATON, ILLINOIS
WE 630-993-8408
FAX 630-993-8418

PROPOSED ADDITION | ELEVATION REVISION TO
WHEATON CAR WASH
812 EAST KOSCIUSKO ROAD
WHEATON, ILLINOIS

DESIGNER REPORT
RESUBMIT DRAWING 5-8-8

COPYRIGHT © 2005
DM+S Architects, P.C.
117 HEATH PLACE
WHEATON, ILLINOIS 60187
ALL RIGHTS RESERVED. NO PART OF THIS PUBLICATION MAY BE REPRODUCED OR TRANSMITTED IN ANY FORM OR BY ANY MEANS, ELECTRONIC OR MECHANICAL, INCLUDING PHOTOCOPYING, RECORDING, OR BY ANY INFORMATION STORAGE AND RETRIEVAL SYSTEM.

PROJECT NO. 510
DATE MAY 8, 2005
DRAWN BY RS
CHECKED BY JLB

A-1
1 OF 2
20-441 SCALE 3/4"=1'-0"

